

Telekom MMS

Employee Experience Solutions.

Betting Game Plugin.

Release Notes Version 2.0



Release Notes – Betting Game 2.0 - Overview.

NEW FEATURES

new

- Prediction groups
- Flexible knockout round scoring
- Transparent betting statistics

IMPROVEMENTS



- Ranking search
- Quick-tip 2.0
- Design facelift
- Optimised ranking calculation



01

New Features.

Prediction groups.

With the new prediction group function, users can create their own groups within the betting game - for even more team spirit and competition among colleagues.

Features & advantages:

- Groups can be created directly by users
- Invitations are sent manually via a request to join or direct invitation within the betting game
- Group size, visibility and other parameters can be configured via the admin panel
- Ideal for departments, project teams or cross-location groups
- In addition to the individual personal ranking list, the ranking list now also includes a ranking list for the betting groups

The image displays three screenshots of the 'Womens European Championship 2025' interface, highlighting the 'Prediction groups' feature.

Top Screenshot: Shows the 'Prediction groups' tab selected. It lists existing groups: 'Workplace Winners' (1 member, Admin button) and 'Marketing Team' (3 members). Below the list is a search bar and a message: 'You can create your own prediction group and join 3 other prediction groups.'

Bottom Left Screenshot: Shows the 'Prediction groups' settings panel. It includes a toggle for 'Prediction groups' (enabled), three checked checkboxes for 'Everyone can create their own prediction group', 'Allow member search', and 'Participants can join multiple prediction groups'. It also features input fields for 'Maximum number of prediction group requests' (3), 'Minimum number for ranking filter' (2), and a 'Participation deadline' field with a calendar icon.

Bottom Right Screenshot: Shows the 'Prediction groups' tab with a 'Join' button next to the 'Marketing Team' group and a 'Join' button next to the 'Office Odds' group. The 'Workplace Winners' group has a 'Join' button with a dropdown arrow.

Flexible knockout round scoring.

Editors now have the option of specifying which results in the knockout matches count towards the points classification.

Setting options:

- Result after regular playing time (90 minutes)
- Result after extra time
- Final result

The setting is made centrally and applies to all players. This allows the prediction game to be flexibly adapted to internal company rules.

Note: The setting can only be selected when creating the betting game round. It can no longer be changed once it has been created.

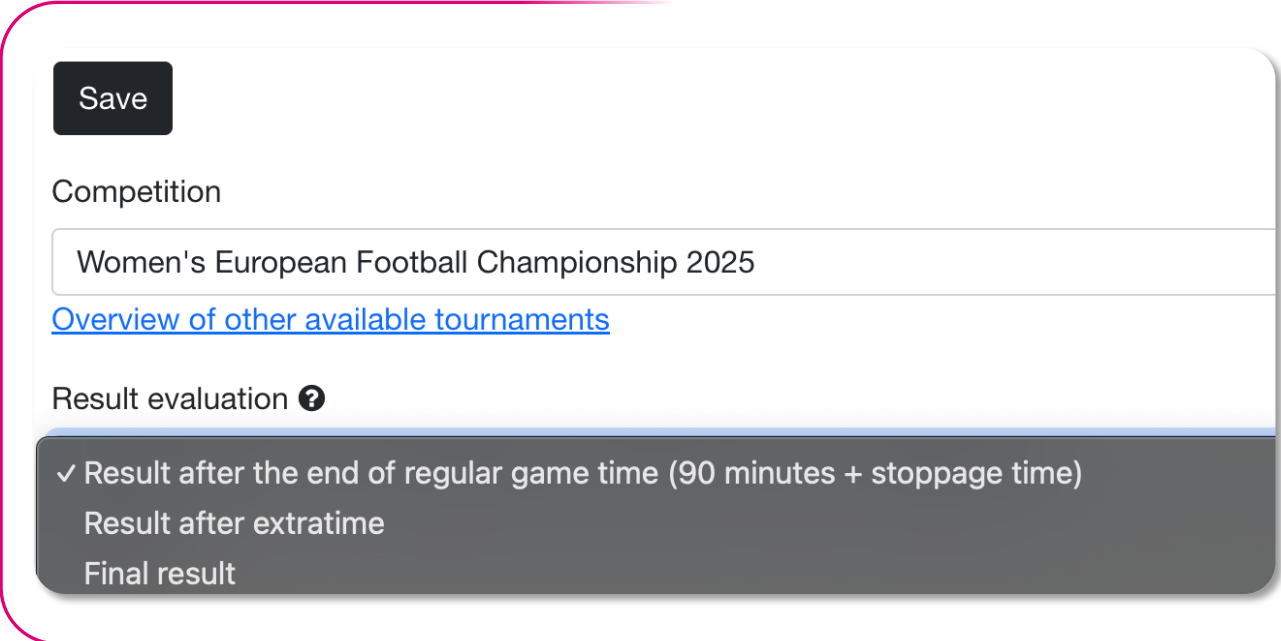

The screenshot shows a 'Save' button at the top left. Below it is the 'Competition' section with a text input field containing 'Women's European Football Championship 2025' and a link 'Overview of other available tournaments'. The 'Result evaluation' section is highlighted with a blue bar and contains three radio button options: 'Result after the end of regular game time (90 minutes + stoppage time)' (which is selected with a checkmark), 'Result after extratime', and 'Final result'.

Save

Competition

Women's European Football Championship 2025

[Overview of other available tournaments](#)

Result evaluation ?

✓ Result after the end of regular game time (90 minutes + stoppage time)

Result after extratime

Final result

Transparent betting statistics.

From now on, the betting game will show detailed statistics on the predictions made - both for individual matches and for bonus questions. This makes for more excitement and discussion among colleagues.

What's new?

- Prediction distribution per match: Once the game has started, you can see how many participants have predicted a win for team A, a draw or a win for team B - including percentages.
- Result quality: You can see how many users predicted the exact result, the correct goal difference or the correct tendency - and how many came away empty-handed.
- Bonus question statistics: After the deadline has expired, you can see how individual colleagues have predicted.
- Filter by betting groups: The statistics can also be filtered by group if groups are activated.



All predictions

Portugal - Belgium
0:3

Select prediction group

Participant	Prediction	Points
Tonya Hines	0:3	4
Shari Reed	0:3	4
Arnold Schleich	0:3	4
Robin Williams	0:3	4
Hanni Wieloch	0:3	4
Philippe Weinhage-Jacobi Jäckel	0:3	4
Samir Warmer	0:3	4
Eric Townsend	0:3	4
Dan Hellwig	0:3	4
Marie-Luise Hermighausen	0:3	4

« 1 2 3 4 5 ... 348 »

Statistics

Draw	Belgium
571 (16%)	1461 (42%)

Difference	Tendency	No points
188 (5%)	1166 (34%)	2017 (58%)

Close

Portugal

Belgium

Result

0:3

Predict closed

03.06.2025 | 19:00

das letzte

Your prediction

Germany

Predict closed

5 Points



02

Improvements.

Ranking search.

🔍 'Where is Alex from Marketing?'

The ranking list is now searchable! Users can find colleagues directly by entering their name without having to scroll through the list.

Details:

- Entering a name or part of a name immediately shows all matching results
- Ideal for large teams with many participants
- Saves time and encourages playful dialogue among colleagues

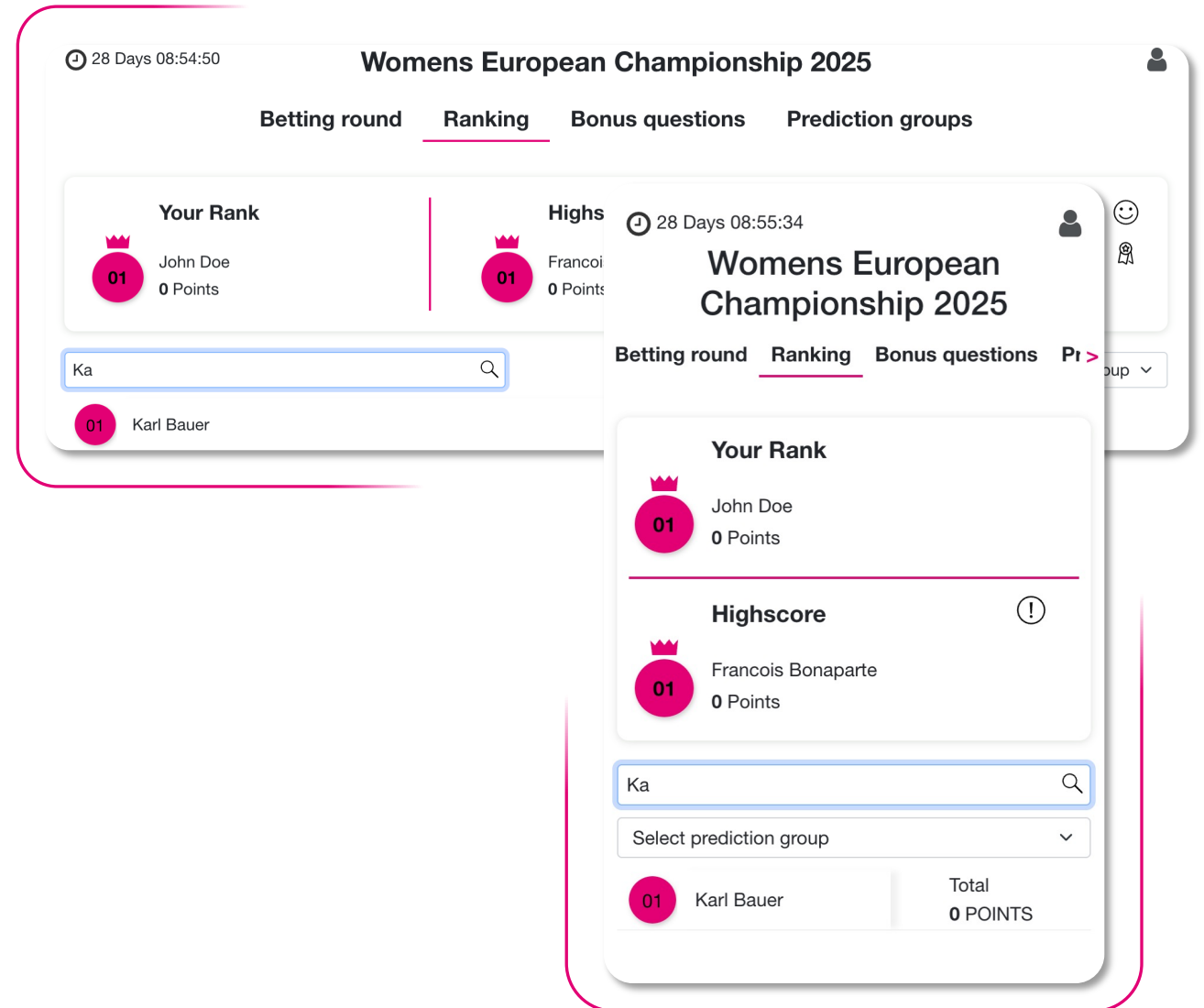

Quick-tip 2.0.

⚡ Predict faster, play along more

The quick-tip function has been fundamentally revised to make the prediction process even easier and faster.

Optimisations:

- More intuitive operation thanks to visual customisations
- Improved mobile usability
- Reduction of clicks and loading times
- Perfect for anyone who wants to predict quickly - even on the move between two meetings.

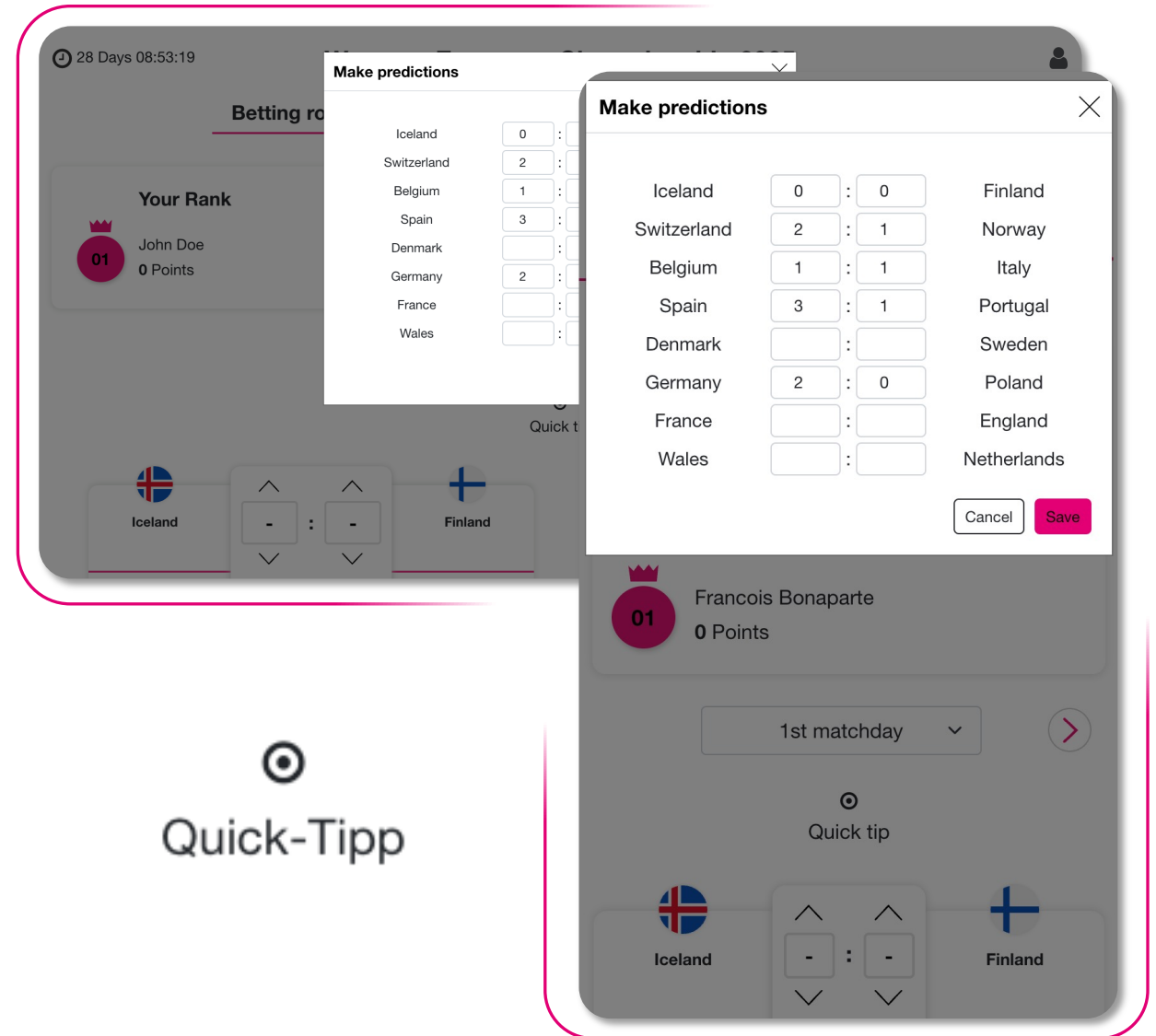

Design-Facelift.

Fine design adjustments ensure an even clearer and more modern user experience.

Examples:

- Improved readability in the ranking list and in the betting community when predicting matches
- New icon sets & spacing for a better overview
- Subtly revised colours and contrasts
- The result: a fresh look with the same ease of use.

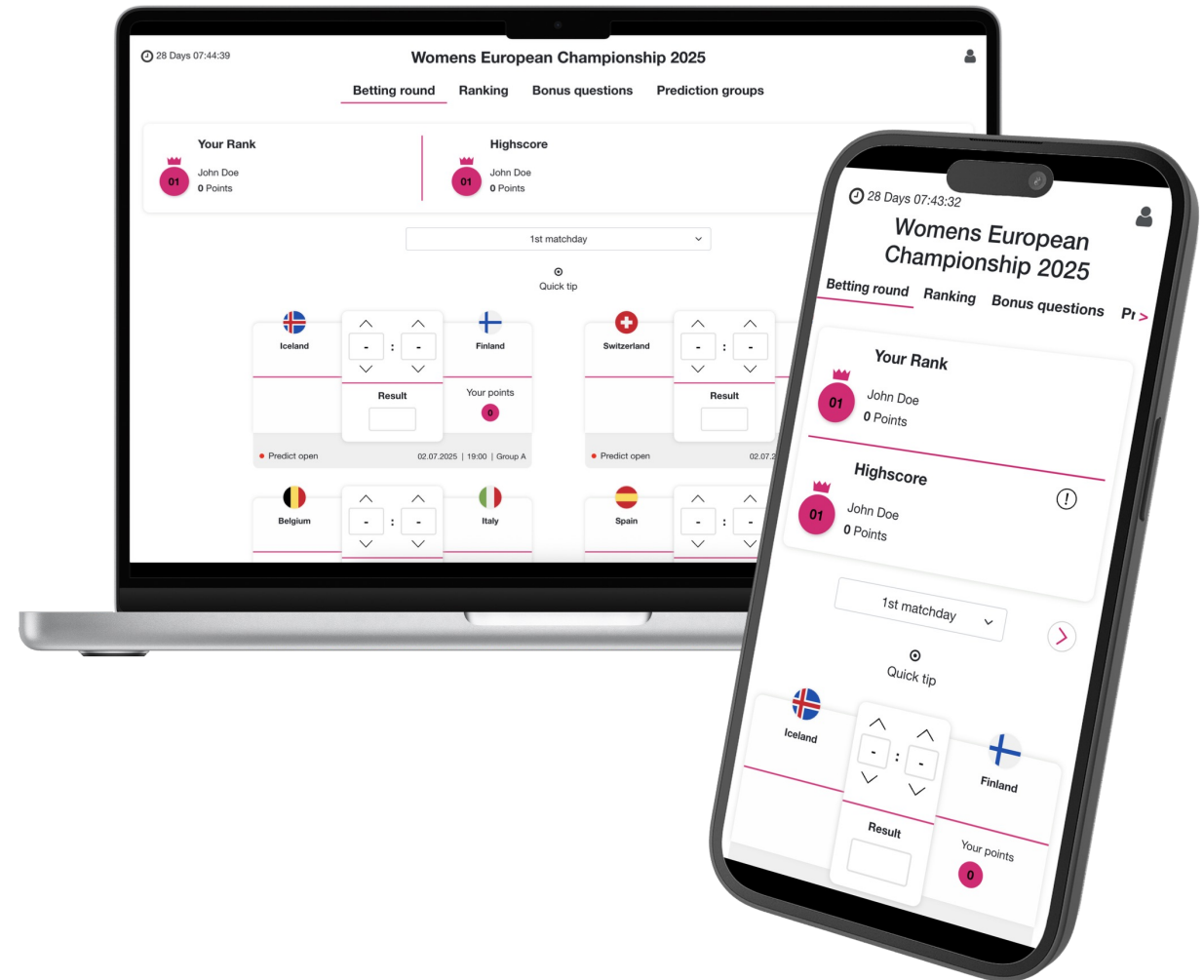

Optimised ranking calculation.

The technical basis of the ranking list calculation has been revised and made significantly more performant - especially in large betting rounds with many participants.

Improvements in detail:

- Faster calculation: Performance has been optimised to avoid delays during live match days
- More stable display: The leaderboard remains stable and responsive even with many parallel updates
- Manual recalculation: Editors can now regenerate the ranking list with a single click if required
- These adjustments ensure a smoother user experience - especially when there is high activity during the knockout rounds.

Questions?

Our team will be happy to help you!



ees-support@telekom.de



Further interesting information and contact details can be found here: <https://employee-experience-store.com/en>